

Suggested Label Dimensions

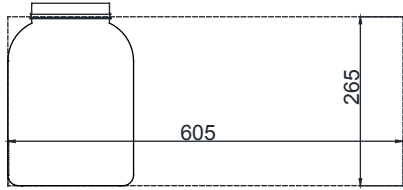

Suggested Sleeve Dimensions

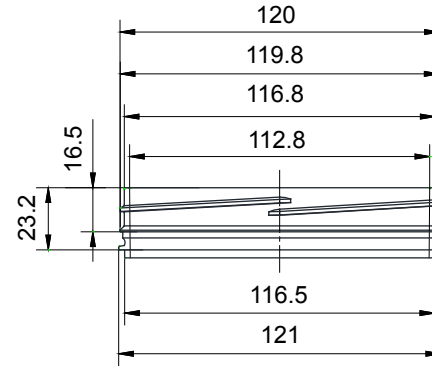
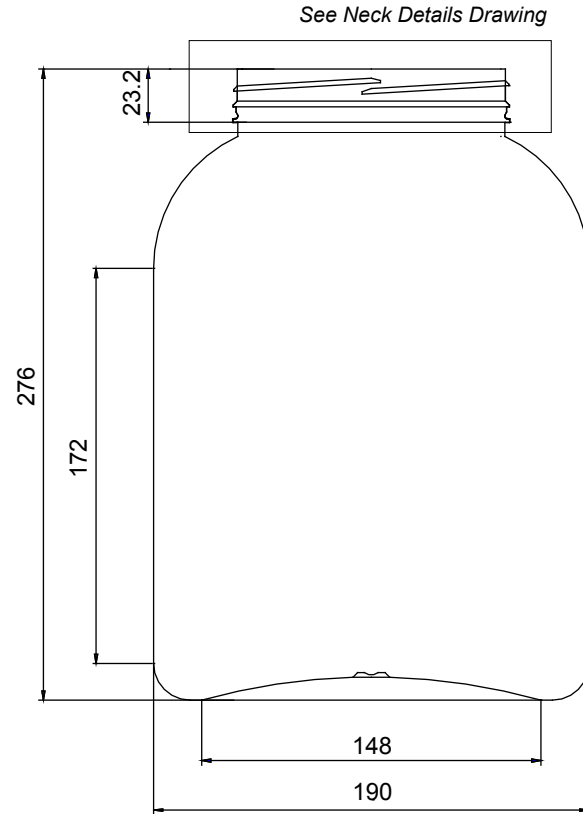

Screw Neck

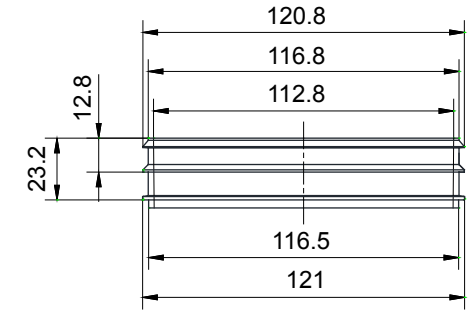

Snap On Neck

**Neck Details**

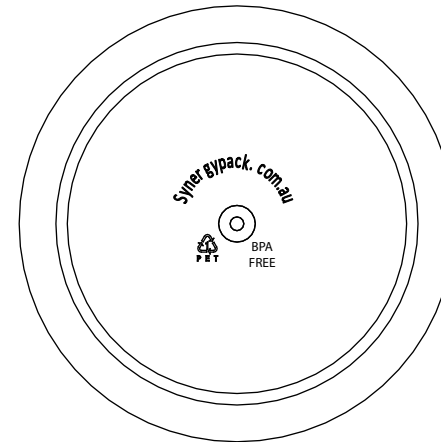

**Bottom View**

Brimful: 6500±300ml

Height/Lengh	Tolerance
<1	±0.2
>1	±0.4
>5	±0.8
>50	±1.0
>100	±1.6
>200	±2.0
Diameter	Tolerance
<25	±0.4
>25	±0.8
>50	±1.2

Material	PET	Drawing no.	W65120NLP-J120-17-01	Controlled Document	
Weight	Min. 250g	Description 6.5L Non Lable Protection Wide Mouth Jar with 120mm Screw or Snap On Neck W65120NLPJRW / W65120NLPJC			
Scale	1:3				
Unit	mm				
Drawn by	A.Song				
Approved by		<h1>Synergy Packaging</h1> <p>* Customer Copy *</p>			
Revision	Date				Modifications
1	30/06/17				Added suggested label and sleeve dimensions
0	15/12/16				